

Lisa Chang Lee

Symphony Zero

31 July - 4 September

Private view: Friday 30 July, 5-8pm

San Mei Gallery is pleased to present *Symphony Zero*, a solo exhibition by London-based artist and researcher Lisa Chang Lee.

At the core of Lisa Chang Lee's practice is a deep interest in the relationship between humanity and the environment in different cultures. Inspired by how Taoist ideology of nature permeates through visual art, music, poetry amongst every aspect in Asian culture, Lee works across moving image, photography, print and collaborative research-based projects with creative partners from other disciplines. Her work is made based on a vitalist conception of life which sees nature as a constant flow of transformation that contains culture rather than a static objectified exterior to man.

Central to the exhibition is the audio-visual installation, *Serenade of the Woods*. This is a project that uses the objectivity of algorithms to examine and challenge the binary opposition between technology and nature. Through data analysis, the rhythm of plants in the breeze is read and then transformed into music scores. Applied with Olivier Messiaen's scale inspired both by music and birds song, the algorithm processes movements of plants swaying in the breeze, recorded from everyday life. Each plant is given a musical instrument that corresponds to its synesthetic form. Eventually, musical scores written by nature are played by humans as a live performance and an audio-visual installation.

Serenade of the Woods explores the act of 'non-doing' using AI and machine learning. Whilst technology is undeniably dominating our everyday life and our ways of experiencing the world, the artist believes that the principle of algorithms is ultimately neutral. The binaries can be computed to help us better comprehend the environment as an ultra-complex organism, as well as reveal the beauty of spontaneity and chance.

Symphony Zero's public programme will include a live performance of virtuoso multi-percussionist Beibei Wang on 21 August.

Lisa Chang Lee is an artist, independent curator and lecturer based in London. She obtained an MA from the Print department at the Royal College of Art in London in 2014, and is now a visiting lecturer at the Central Academy of Fine Art in Beijing, at the Royal College of Art in London and curator of Print Future Panel of International Printmaking Triennial at China Academy of Art (CAA). Recent solo and group exhibitions include *Indeterminate Loop* at Ginkgo Space Beijing (2020, China); *Serenade of the Woods* at the Rattles Collective London (2019, UK); *Seoul Biennale* (2019, Korea); *Unstable Landscape*, M100 Contemporary Art Centre (2018, Chile); York Art Gallery (2018, UK); Shenzhen/HK Bi-City Biennale of Urbanism and Architecture (2017, China). Her work features in the permanent collections of Victoria and Albert Museum (UK); The Royal Collection (UK); British Museum (UK); Ashmolean Museum (UK); Metropolitan Museum (US).

San Mei Gallery

www.sanmeigallery.co.uk info@sanmeigallery.co.uk [@sanmeigallery](https://www.instagram.com/sanmeigallery)

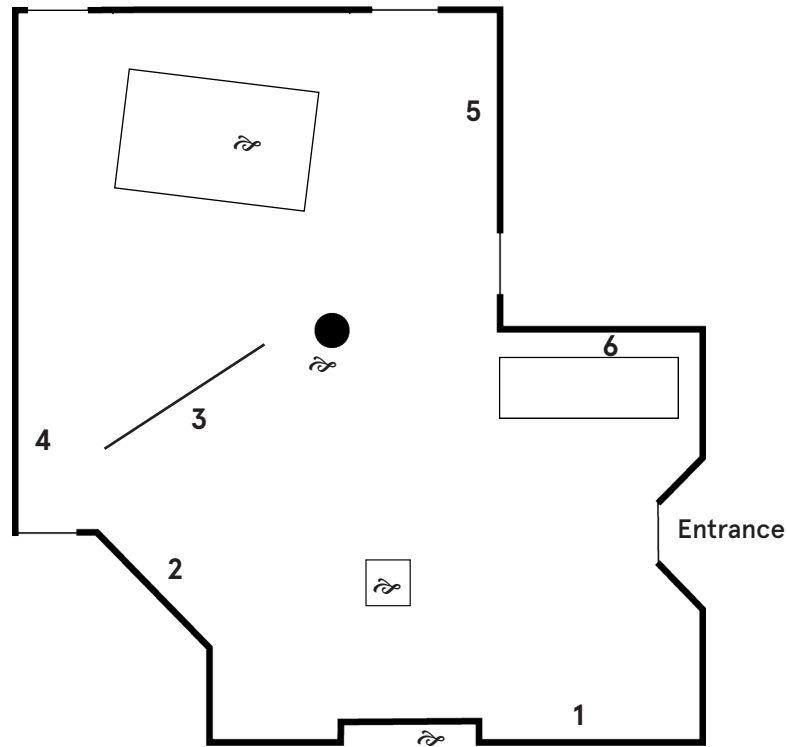

1
Lisa Chang Lee
A Song at Dusk
 digital c-type
 140 x 78.4cm
 edition: 5 + 1AP
 2021
 £1200

2
Lisa Chang Lee
*"Learn to Fear, As Fear is the
 Greatest Bond of All"*
 digital print and mix media
 drawing on paper (framed)
 30 x 34cm each
 unique work
 2021
 £1140

3
Lisa Chang Lee
Serenade of the Woods
 AV installation
 edition of 5
 2019
 Price: POA

4
Lisa Chang Lee
Unseen Presence
 digital print and mix media
 drawing on paper (framed)
 50 x 29cm
 unique work
 2021
 £650

5
Lisa Chang Lee
Soundscape of Woodland
 Four colour screenprint with
 metallic powder
 edition of 50, framed
 2019
 £579

6
Lisa Chang Lee
*Serenade of the Woods Limited
 Edition Artist Vinyl*
 limited edition artist vinyl, USB
 stick, publication
 edition of 100 (12 available)
 2019
 £210

∞
Lisa Chang Lee
Extra-ordinary, 2021
 bronze casting with enamel
 paint
 15 x 13 x 7cm
 NFS